

AST PLAN 92

HERMETIC SEALING SYSTEM FOR BEARING FRAMES AND GEARBOXES

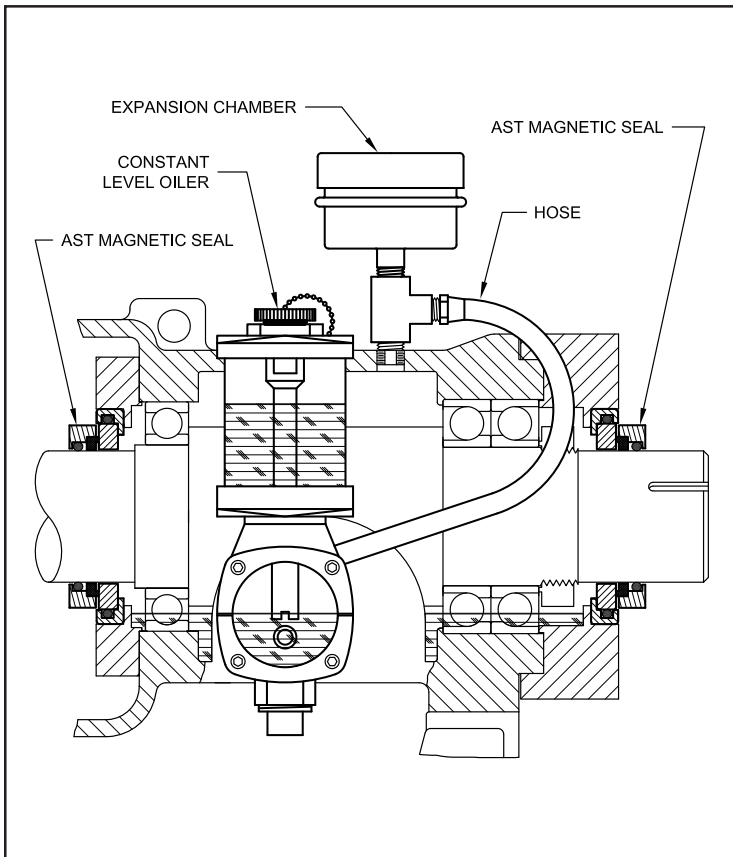

OFF THE SHELF

AST 40 magnetic seal bearing isolators provide positive sealing for bearings in process equipment. The AST Plan 92 system excludes moisture and contaminants from pump bearing frames and gearboxes, extending bearing life.

AST Plan 92 packages to fit popular ANSI pumps are available from stock.

Premature bearing failure has long been a problem of process pumps. Studies show that contamination of the lubricating oil by water causes 98% of all pump bearing failures. The AST Plan 92 sealing system protects bearings by hermetically sealing the bearing housing against moisture and particulate contamination.

After 2000 to 3000 hours of operation, the lip seals installed in most pumps have worn to the point that they no longer protect against contamination. Since the shaft under the lip seal wears as well, replacing a lip seal won't stop leakage. The labyrinth bushings installed as an "upgrade" in some pumps don't wear, but don't seal against moisture even when new. AST 40 Magnetic Seals are positive contact face seals which exclude dust, dirt, grit, atmospheric moisture, and water from pump washdown.

Moisture can also enter the bearing housing through the vent cap or breather. The AST Expansion Chamber allows thermal expansion of the air in the housing by movement of a tough Buna-N diaphragm in a protective steel casing. Not only is moisture excluded, but oil vapors are prevented from escaping to the environment.

The AST Constant Level Oiler completes the Plan 92 system. The oil reservoir is sealed from the atmosphere. A hose from the oiler to the expansion chamber equalizes pressure so proper oil level is maintained.

By sealing the three possible entries into a bearing housing against moisture and contaminants, the AST Plan 92 system extends bearing life in hostile environments.



AST
Mechanical Seals

AST 40 MAGNETIC SEALS

AST 40 Magnetic Seal Bearing Isolators are mechanical seals, not just labyrinth bushings. The rotary seal face is kept in contact with the stationary face by magnetic attraction rather than springs, so the seals are compact enough to replace lip seals.

SIZES:

To fit shafts from 1.000 to 3.000 inch. Off-the-shelf seal packages are available for popular ANSI pumps.

OPERATING LIMITS:

Pressure: 25 PSID (1.7 bar) from seal case side

2 PSID (.14 bar) from magnet side

Temperature: -20°F (-30°C) to 400°F (205°C)

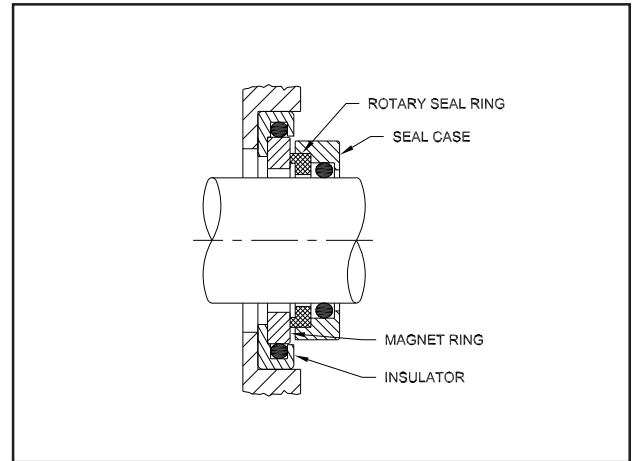

CONSTANT LEVEL OILER

MATERIALS OF CONSTRUCTION:

Body: Cast aluminum

Reservoir: Acrylic

Sight glass: Pyrex

Seals: Buna-N

OPERATING LIMITS:

Pressure: 30 PSI (2 bar)

Temperature: 160°F (70°C) maximum

225°F (105°C) maximum with optional Pyrex reservoir

CAPACITY: 5 ounces

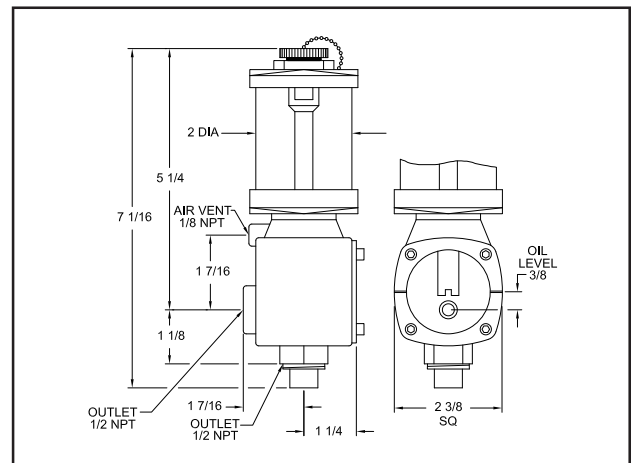

EXPANSION CHAMBER

MATERIALS OF CONSTRUCTION:

Case: Steel, zinc plated

Diaphragm: Buna-N

OPERATING LIMITS:

Pressure: 30 PSI (2 bar)

Temperature: -20°F (-30°C) to 250°F (120°C)

CAPACITY: 16 cubic inches

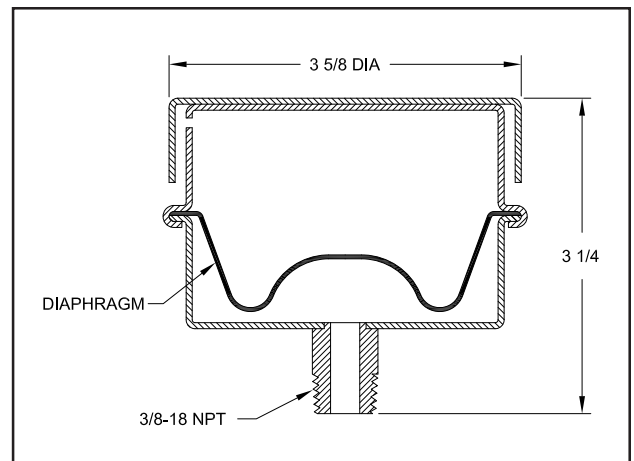

AST ADVANCED SEALING
TECHNOLOGY

DISTRIBUTED BY:

250 NORTH STREET A-11
DANVERS, MA 01923 USA
www.astseals.com

(978) 750-8001
FAX: (978) 750-6980
sales@astseals.com